

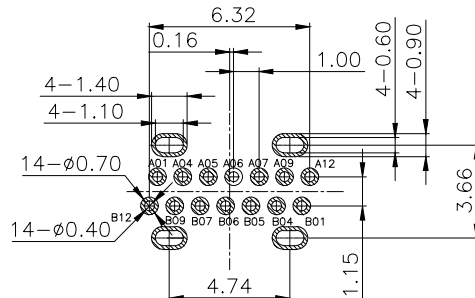

| | | | |
|-----|-------------|------------|----------|
| REV | DESCRIPTION | DATE | APPROVED |
| A | 新版发行 | 2023.07.28 | HHM |

SPECIFICATION:

- ELECTRICAL:
 - CURRENT RATING:5A;
 - CONTACT RESISTANCE:40mΩ Max;
 - DIELECTRIC WITHSTANDING VOLTAGE:150V AC;
 - INSULATION RESISTANCE:150V DC/100 MΩ MIN;
- MECHANICAL;
 - MATING FORCE:5~20N;
 - UNMATING FORCE:8~20N;
 - DURABILITY:10000 CYCLES;6~20N AFTER DURABILITY TEST;
- MATERIAL:
 - HOUSING&MOLDING:LCP UL94V-0;
 - TERMINAL:C7025 T=0.15mm;
 - SHELL:SUS304 T=0.30mm;
 - MID PLATE:SUS304 T=0.20mm;
- PLATING SPECIFICATION:
 - TERMINAL:CONTACT POINT GOLD PLATED 3u" MIN
PIN WELDING AREA GOLD PLATED 1u" MIN.
 - SHELL:PLATED Ni 60u" MIN(Salt spray 48H)
- ELECTROPLATED PRODUCTS NEED TO UNDERGO TIN ADHESION TESTING: THE TIN ADHESION AREA SHOULD REACH OVER 95%.
- SMT REFLOW SOLDERING (PEAK VALUE 260 ° C ± 5 ° C) SHALL BE FREE OF BLISTERING, GLUE MELTING AND POOR COLOR CHANGE (DEFORMATION WITHIN TOLERANCE)
- OPERATING TEMPERATURE: -40° C~+85° C

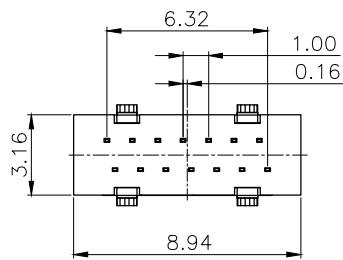
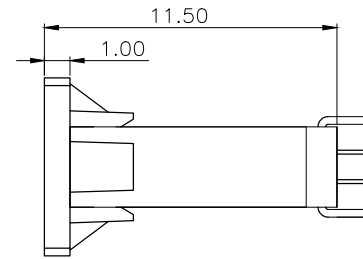
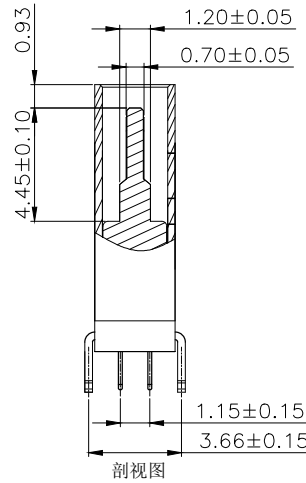
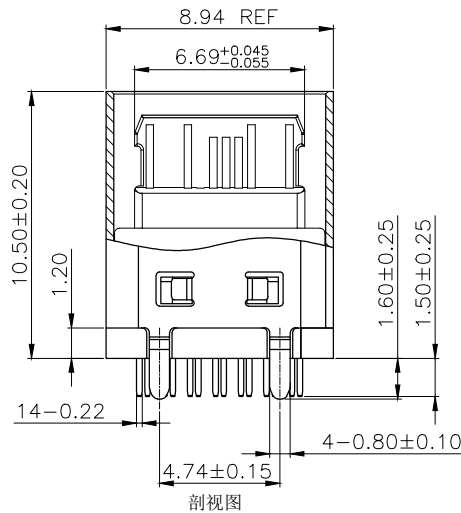
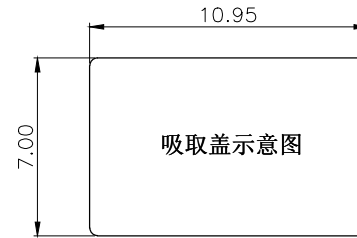
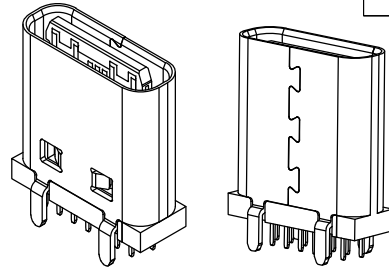
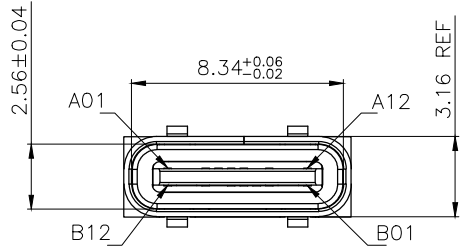

RECOMMENDED P.C.B. LAYOUT(俯视图)
TOLERANCE UNSPECIFIED ±0.05mm

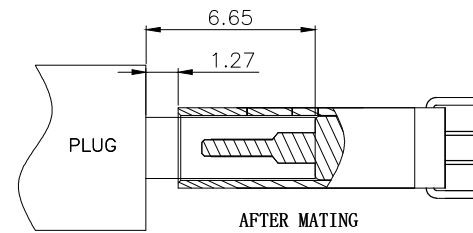

| | | | |
|-----|-------------|-----|-------------|
| A1 | GND | B12 | GND |
| A4 | VBUS | B9 | VBUS |
| A5 | CC1 | B7 | Dn2 |
| A6 | D+ | B6 | Dp2 |
| A7 | D- | B5 | CC2 |
| A9 | VBUS | B4 | VBUS |
| A12 | GND | B1 | GND |
| PIN | SIGNAL NAME | PIN | SIGNAL NAME |

| CUSTOMER DRAWING | | |
|---|----------------------|---|
| UNITS mm | SCALE 1:1 | SHEET 1 OF 2 |
| PROJECTION: | DRAW: DAP | |
| GENERAL TOLERANCE .000 ±0.15 .00 ±0.20 .0 ±0.25 .0 ±2° .00 ±1° | CHECK: HWT | MAT'L SEE TABLE FINISH SEE TABLE |
| | APPD: HHM | |
| | DWG. NO. A031406A | |
| | | SIZE A4 |

铭创科技(东莞)有限公司
Mingchuang Technology (Dongguan) Co., Ltd.

TITLE
TYPE C母座14PIN 立式四脚插版DIP L=10.5 A款

DWG. NO. A031406A
PART NO. _____
SIZE A4

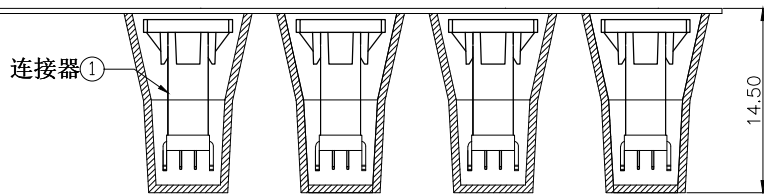
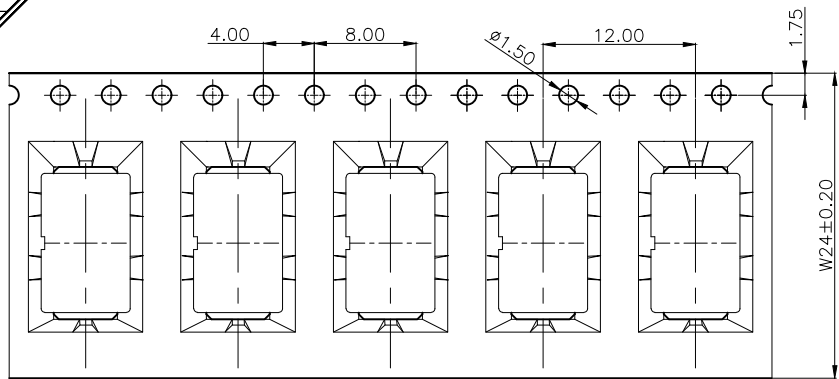
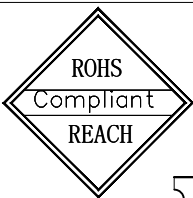

产品入载带示意图

剥离角度: 165°~180°
剥离力: 40gf~120gf
用户取件方向

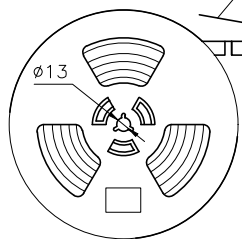
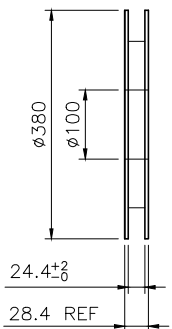

卷盘示意图

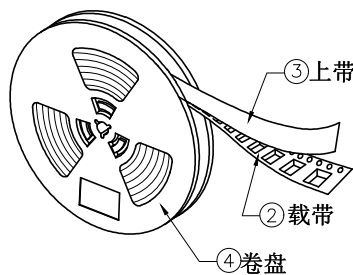

| REV | DESCRIPTION | DATE | APPROVED |
|-----|-------------|------------|----------|
| A | 新版发行 | 2023.07.28 | HHM |

包装示意图

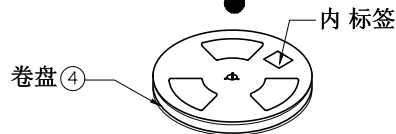
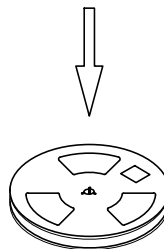

卷盘贴标签示意图

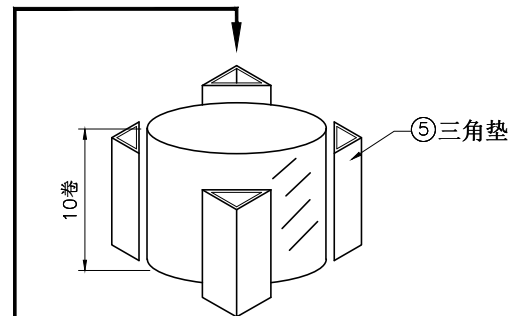

10盘产品叠层示意图

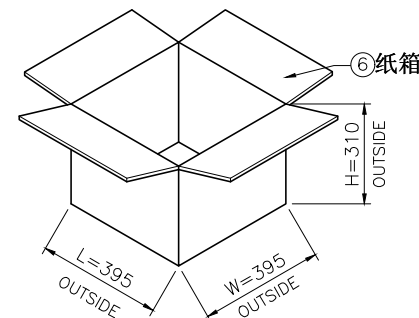

技术要求:

1. 载带首尾各留出12PCS空格不装产品;
2. 每穴放置1PCS产品, 每卷装600PCS产品, 放置方式如图所示;
3. 将包装好的产品;每盘必需贴上内标签;将贴好内标签的产品每10盘堆叠。
4. 在纸箱四角垫上4个三角垫, 然后把装好产品的卷盘放入纸箱中, 最后用胶带封箱; (如客户有要求, 请按客户要求包装出货)
5. 上带与载带的剥离力: 40gf~120gf, 跳动量在30gf内; (剥离角度: 165°~180°, 剥离速度: 250~300mm/min)
6. 产品符合RoHS环保标准要求。

| | | | | |
|----|------|-----------|----------------------------|----------|
| 06 | 纸箱 | B-05-0012 | 395mm*395mm*310mm | 1 PCS |
| 05 | 三角垫 | / | 300mm*260mm*7mm | 4 PCS |
| 04 | 卷盘 | B-02-0001 | D=380mm, d=100mm, H=28.5mm | 10 PCS |
| 03 | 上带 | B-04-0002 | W=20.7mm, T=0.05mm | 7488 mm |
| 02 | 载带 | B-03-0011 | W=24mm, T=0.50mm, P=12.0mm | 7488 mm |
| 01 | 连接器 | A031406A | 14PIN, DIP | 6000 PCS |
| 序号 | 物料名称 | 物料编号 | 规格 | 描述 |

| CUSTOMER DRAWING | | | 铭创科技(东莞)有限公司 Mingchuang Technology (Dongguan) Co., Ltd. | | |
|---|--------------|-----------------|--|----------------------|-------------------|
| UNITS mm | SCALE 1:1 | SHEET 2 OF 2 | TITLE TYPE C母座14PIN 立式四脚插版DIP L=10.5 A款 | | |
| PROJECTION: | | DRAW: DAP | | MAT'L SEE TABLE | |
| GENERAL TOLERANCE .000 ±0.15 .00 ±0.20 .0 ±0.25 .0 ±2° .00 ±1° | | CHECK: HWT | | FINISH SEE TABLE | |
| | | APPD: HHM | | DWG. NO. A031406A | PART NO. _____ |
| | | | | SIZE A4 | |